

# alfda<sup>®</sup>

user manual



Dehumidifier  
AEF2000

## Table of contents

Warnings	3	Notes for use	14
Preaucaution	4	Cleaning of the dehumidifier	15
Components & installation instructions	6	Technical dates	16
Display-indication & control panel	7	Problem solving	16
Operation & function	8	Notes	18
Insert additional filterfleece (opt.)	11	Warranty conditions	19
Water tank / drainage-tube	12	Notes for disposal	20

Dear customer!

Thank you very much for purchasing our alfda® Luftentfeuchters AEF2000.

Please read the operating instructions carefully before using it for the first time.  
This manual contains important notes for the ideal use and handling of the device.  
Please keep the instructions after reading in case of any upcoming questions in the future.

This air dehumidifier removes unpleasant moisture in everyday life and also serves to dry washed laundry indoors. It is not suitable for keeping the humidity very low (about 50% or less relative humidity in the room).

The room temperature may rise during operation! This dehumidifier has no cooling function. During operation it generates heat and the room temperature rises by 1°C to 4°C depending on the size of the room. The temperature also rises if the unit is operated in a cabinet or similar. An increase in the room temperature can also be caused by closed windows and doors, solar radiation or other technical devices.

There may still be a small amount of water in the tank as your dehumidifier has undergone a short factory test after production.

### Service-Adress:

alfda Artikel für Allergiker Handels-GmbH  
Wörth 19  
DE - 94034 Passau

Phone: +49 (0)851 / 85 16 38 – 88  
Fax: +49 (0)851 / 85 16 38 – 30  
E-Mail: [verkauf@alfda.de](mailto:verkauf@alfda.de)  
Internet: [www.alfda.de](http://www.alfda.de)

Our WEEE-Reg.-Nr.: DE 87819261

## Warnings

Please read the listed warnings carefully, before using the dehumidifier. These must be observed for a safe use.

- In case of technical problems, please be sure that the dehumidifier is turned off, take out the power plug and get in contact with the seller of your device or with our after-sales-service-hotline. Only turning off the device won't switch off all consumers. Running the device while there are technical problems can cause a breakdown of the device, electric shocks, fire or similar problems.
- Before you connect the power plug, make sure that there is no dust or damp on the power plug. Only plugs with power from 220-240V AC are allowed to be used. Please always use dry hands when using the power plug, in order to avoid electric shocks. Never turn off the dehumidifier by pulling out the plug. The device must be plugged according to connection regulations. If the power plug is corrupted it must be replaced by producer, customer service or a similar qualified person.
- Please never open the dehumidifier by yourself and do not technical modifications or repairs to the dehumidifier. Only the producer or authorized specialized companies, which are specialized on flammable refrigerants are allowed to repair the device. Don't plug the dehumidifier in a plug which electric line is below the dehumidifier. The plug must not be damaged or modified. Therefore, do not clamp the cable into any doors and do not place hot or heavy objects on the cable. Do not pull the cable out or bundle it during operation.
- Do not sprinkle water or any other liquid in the dehumidifier in order to avoid a fire or explosion. Do not lay down flammable things or chemicals on the device or near the device and do not put the dehumidifier next to a heater. Never plug poles or things in the entrance of the dehumidifier, because in the device there is a fan which runs with high speed.
- Dispose the water which is collected in the tank only in the drain. The drinking or further use of the water can cause damage to the health. Do not use any other products than those recommended by the manufacturer, to clean the unit or speed up defrosting. Note that refrigerant is odourless.
- Cut off the power supply, before repair the device. Do not use the device when the back cover is missing. Components inside of the device could be very hot and there is a risk of getting an electric shock.
- Only use the device in a room in which there are no ignition sources (open flames, gas appliances, electric heaters). Never burn or bore the device.
- The device is not suitable for children or people with reduced physical, sensory or mental abilities. A lack of knowledge and know-how is a potential risk when using it.

That's why persons only should use it after explicit instructions and oversight of another person, which is responsible for the safety. This person also should make sure that children are not playing with the device.

## Preaution

- The dehumidifier must be used on a flat and stable underground.
- Only use the device upright (standing), in order to avoid malfunctions or unusual noises. After the transport let the device stand up straight for at least 24 hours. Otherwise defects on the compressor could be caused.
- In order to avoid freezing water do not use the dehumidifier and the drainage if the temperature is below 0 °C.  
Do not use the dehumidifier outside. Direct sun irradiation or rain can cause overheating, electric shocks or fire.
- Do not put a water bottle on the dehumidifier.  
If water is spilled it could get into it and cause damage on the device.
- Never try to use the device for another purpose (f.e. conservation of food or art objects). The device is not made for this and the conservation quality could be damaged when using wrong.
- Do not use the dehumidifier in places where oil or flammable gases may escape or where the unit is exposed to chemicals.
- Ensure that continuous emptying is ensured when using the drain hose (no gradient).
- Make sure that heaters are not exposed to the exhausted air of the dehumidifier.
- Do not use the dehumidifier as a chair or footstool.
- For safety reasons: unplug the the device if it wont be used for a longer period of time.
- Hold the power plug firmly and securely on the insulated side when plugging it into or unplugging it from a wall outlet! Never touch the metal contacts of the plug.
- If you use the dehumidifier in a wardrobe make sure that there are no children in the wardrobe or that they get a chance to get into the wardrobe.
- Do not remove the float switch from the water tank.
- Never move the connected device beyond the maximum range of the power cord. Forcibly pulling the power plug out of the wall outlet may damage it or the power cord.
- Do not block the air inlets and outlets. Do not cover the appliance with washed clothes, blankets or similar.
- For a permanent operation over a longer period of time it is nessecary to regularly check the device (esp. air purification, drainage or similar)
- Turn off the device and plug the plug, before you start with cleaning or other routine maintenance.
- To avoid electric shocks while cleaning never spray or spill water on the device.
- Turn off the device and clear the water out of the tank, before you move the device. Hold the carrying handle safe & tight.
- If possible do not use extension cable or any additional plug connection for the device. If necessary please only use tested moisture-proof extension cables, like the one they sell in electronic shops.

### Informations about how to deal with refrigerants:

- Do not damage any components of the refrigerant circuit.  
Outflowing refrigerant might not be noticed, because its odorless.
- Devices with flammable refrigerants
- Please take care of the statutory gas regulations
- Work on a refrigerant circuit may only be carried out by persons who have a currently valid certificate from an accredited assessment body to ensure safe handling of refrigerants in accordance with an assessment specification recognised throughout the industry.



#### **WARNING: FIRE RISK!**

**This device contains flammable refrigerants R290. There is a fire risk, when the refrigerants flews out and is exposed to an external ignition source.**

## Components



## Placement

For a efficient use of the dehumidifier take note of the minimum distances like in the picture:

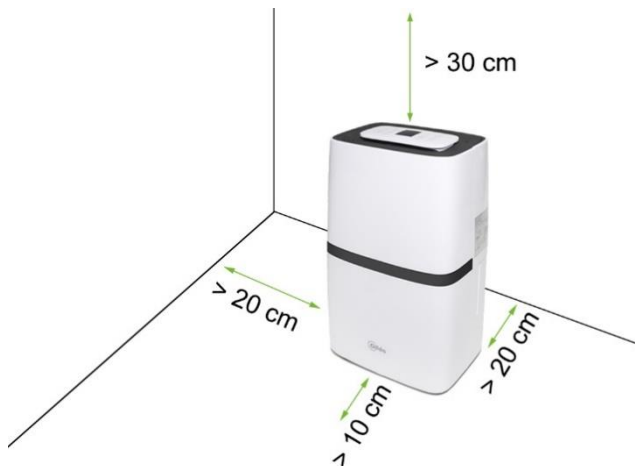

**IMPORTANT:** If reception signals from television sets, radios etc. are disturbed, please ensure a minimum distance of 70 cm between the affected device and the dehumidifier!

## Display (Touch-Panel)

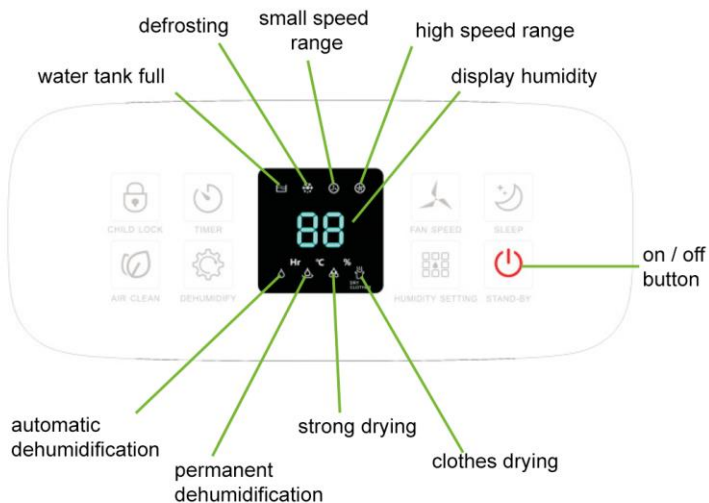

Water tank full: When the water tank is full, the control lamp lights up. 🚰

### Colour-indicator-display:

Using a humidity sensor, your dehumidifier measures the relative humidity in the room, shows it on the display and in the form of a three-colour indicator display (see picture):





- BLUE    relativ humidity in the room:    30% - 50%
- GREEN    relativ humidity in the room:    50% - 70%
- RED    relativ humidity in the room:    70% - 80%



## Operations and functions of the dehumidifier:



### DEHUMIDIFY MODE (choice of different modes)

By pressing the button "DEHUMIDIFY MODE" you can select different operating modes according to your needs. The unit starts in automatic dehumidification mode  the first time it is switched on. By repeatedly pressing the "MODE" button, you can switch to the permanent dehumidification , heavy drying  or clothes drying  modes.

We recommend the listed modes for the following situations:



#### Automatic Mode

- to dehumidify a room or remove dew from ceiling and or / walls
- to avoid the formation of mould

In this mode you can choose between low and high fan intensity via the FAN-SPEED button!



#### Permanent-dehumidification

- to dehumidify a closet

In the „permanent dehumidification“ operating mode, the fan runs at a low level



#### Strong drying

- Maximum dehumidification performance at very high humidity.

In the „heavy drying“ operating mode, the fan runs permanently at maximum speed.



#### Clothes drying

- to dry washed laundry, carpets, runners, blankets, etc. quickly
- to dry small surfaces and corners or wet shoes.

In this operating mode, the fan only runs at high speed.



#### Air Clean (no dehumidification)

- to clean the air in a room

In this mode you can choose between low and high fan intensity via the FAN-SPEED button!

Note: Your dehumidifier saves the selected operating mode as soon as you have set it. After an interruption in operation, your dehumidifier will start in the last saved mode the next time it is used. If the power supply is disconnected by unplugging the power plug or in the event of a power failure, reset the settings if necessary.



#### CHILD-LOCK

Press and hold the button for 5 seconds to disable the control. Press the button again for 5 seconds to unlock.





### **TIMER (set operating time)**

- You can activate the timer function in any operating mode by pressing the "TIMER" button. After pressing the "TIMER" key, the display shows "Hr" for hours and "00" for the number of hours. The display "Hr" lights up during the complete timer operation. Before programming, make sure that the timer function is not already activated (the display must not show "Hr").

- By repeatedly pressing the "TIMER" button, you can set the desired operating time in 1-hour intervals up to a maximum operating time of 24 hours. Pressing the "TIMER" button at the maximum operating time of 24 hours resets the timer to 00 hours.
- To change the timer setting during timer operation, press the "TIMER" button. By pressing the "TIMER" button again, the operating time can be increased by one additional hour of operation.
- To cancel the timer operation, press the "TIMER" key repeatedly until 00 is displayed as the operating time. The display "Hr" for the timer mode will then go out.
- The operating time starts automatically after the desired value has been entered. Your dehumidifier stops operation as soon as the specified number of operating hours has been reached.
- The timer operation mode is stopped when the water tank is full. As soon as the water tank is emptied and correctly reinstalled in the appliance, the timer operation is automatically continued until the previously set number of hours has elapsed.



### **AIR CLEAN**

- Press the "Air Clean" button to activate the air cleaning function. The key indicator lights up during operation of this function.
- The air is cleaned by a plastic prefilter on the back of the unit. This filter can be used without restriction as long as it is not damaged. Please clean the prefilter regularly (e.g. by carefully vacuuming with a vacuum cleaner).
- For improved air cleaning, we recommend the use of an additional air filter fleece, which you can optionally purchase in our shop (see page 11).
- The compressor of the dehumidifier is thus switched off. No dehumidification takes place in this operating mode. You can set the speed of the fan as desired (level 1 low / level 2 high).



## HUMIDITY SETTINGS

- You can set the desired humidity in the range of 30% - 80%. Press repeatedly to increase the setting value at 5% intervals.
- Once the maximum value of 80% has been reached, pressing the key again will restore the minimum value of 30%.
- This setting can only be selected in "Automatic dehumidification" mode. The dehumidifier stops dehumidification automatically as soon as the value falls below the selected value and restarts if necessary and continues the dehumidification function.



## FAN-SPEED

- Use the FAN SPEED button to select the desired fan speed. There are two operating levels for this: Low and high speed levels are shown on the display.
- The fan speed can only be selected in the operating modes "Automatic dehumidification" and "Air Clean" (air cleaning). In the "Permanent dehumidification" operating mode, the fan automatically runs at a low speed. In the operating modes "Heavy drying" and "Clothes drying" the fan automatically runs at a high level - a manual change of the fan speed is not possible in these operating modes!



## SLEEP (Nachtmodus)

- After pressing the "SLEEP" button, the sleep mode is activated. This turns off the display illumination and the color indicator for humidity. Please select the desired fan speed before activating the sleep mode, as far as this is possible in the selected operating mode. You can also reduce the operating noise of the dehumidifier by selecting the small fan speed beforehand.
- By pressing the button again, the sleep mode is deactivated.
- The dehumidifier resumes its normal operating mode and the display is reactivated.



## POWER/STAND-BY (Ein-/Ausschalter)

- Press this key to start the dehumidifier.
- Press the key again to switch off the unit.

## Insertion of an additional air filter fleece in the dehumidifier:



Warning: Switch off the appliance and disconnect the power supply.



1.

Remove the cover (filter holder) from the rear of the dehumidifier by pulling the handle provided.



2.

Before installation, remove the air filter fleece from its packaging and place it in the filter holder provided. The additional air filter fleece is inserted into the holder so that the coarser plastic prefilter remains on the outside of the plastic grille.



3.

Replace the filter holder in the unit by first inserting the two fixing straps on the top into the eyelets of the dehumidifier and then pressing the filter cassette lightly against the bottom of the unit until it clicks into place.

You can order the air filter fleece comfortably in the double pack (2 pieces) under the article number 159712 in the online shop of the manufacturer:

<https://www.allergiker-shop-alfda.de>

This is a coarse dust filter of filter class G3 with a separation of 80% - 90% for particles >10 µm (e.g. construction site dust). In addition to air cleaning, this fleece also provides additional protection against soiling for your dehumidifier during normal dehumidification operation. The use of the optional air filter fleece reduces the air throughput compared to the use without fleece.

Please note that the CLEAN-AIR function of the dehumidifier and the coarse dust filter used are **NOT** HEPA-filters, which are usually used for air cleaning by allergy sufferers. If required, we

therefore recommend an alfa® air purifier with HEPA filter, which filters fine dust and the smallest particles.

## Water tank / Drainage-tube

Your dehumidifier will stop operation if the water tank is full or has not been properly inserted into the appliance.



### Removing the water tank

Step to the rear of the dehumidifier and grasp the left and right recesses provided between the tank and the appliance. Slowly press the container in your direction with your thumb and fingers so that the tank is released from the unit. Carefully remove the tank from the dehumidifier with both hands so that no water is spilled.

To carry the tank, you can fold out the carrying handle provided.



Slowly empty the tank into the drain by tilting the container as shown in the photo.

### Inserting the water tank

To insert the water tank, first place the empty tank behind the appliance and fold the carrying handle into the recess provided. Then carefully lift the tank with both hands and insert it straight into the recess of the dehumidifier. For the last 3 cm, hold one hand against the front of the dehumidifier and gently push the tank into the appliance with the other hand.



**PLEASE NOTE:**

During the dehumidification process, water collects in the water tank. If the water tank is full, the dehumidifier switches off automatically and a signal tone sounds. This is also indicated by a signal light on the display. In this case, the other symbols (e.g. operating modes) are hidden, as operation can only be resumed after the water tank has been emptied.

If the tank is removed during operation of the dehumidifier, a signal tone will also sound for approx. 20 seconds.

**Use of drainage hose (instead of water tank)**



Alternatively, the water can be led permanently into a floor drain by means of a drainage hose. The condensate drain is located on the back of the unit to which you can connect the drainage hose.

Place the supplied drainage hose on the drain nozzle and make sure that the connection is tight and that no water escapes. To gain better access, you can remove the water tank from the unit for this procedure.

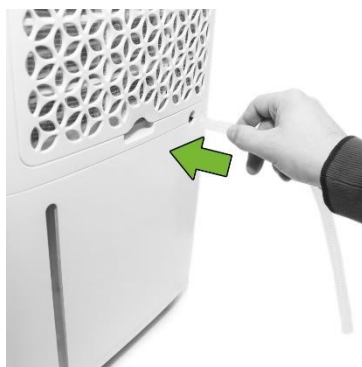

When using the drainage hose, make sure that there is a continuous slope of the hose to ensure proper emptying. The water hose can be directed to a floor drain or other suitable drain. In any case, the drain must be lower than the condensate connection of the unit.

Note: When using the drainage hose, the water tank must be inserted in the unit.

If the permanent drainage by means of a drainage hose is not used, please remove the hose from the condensate drain. The condensation water is then returned to the water tank.

## Signal tone

Each keystroke is confirmed with a signal tone. If there is no beep, make sure your finger is on the correct symbol on the touch screen.

## Hints for use

To protect against frequent switch-on cycles, the compressor is provided with a standstill time of 3 minutes. If, for example, the dehumidification process is interrupted by disconnection from the mains supply or manual shutdown and the unit is then put back into operation, the compressor will not restart until the 3-minute shut-off period has elapsed.

The performance of the dehumidifier is also affected by the air outside the room. For efficient operation, please close all windows and doors in the room.

If the ambient temperature exceeds 36° C, the dehumidification process is stopped for safety reasons and the unit automatically switches to air cleaning mode.

The circulation of the refrigerant may cause operating noises in the dehumidifier when starting. As soon as the circulation is stable, the operating noise is also reduced.

## Defrosting

- During defrosting, both the dehumidification function and the air cleaning function are deactivated. During this procedure, the "Defrost function" indicator ❄ lights up on the display.
- Do not unplug the appliance during defrosting and do not switch off the appliance.

## Operation with an external timer or WLAN socket outlet

The dehumidifier can be switched on and off via a standard external timer or by using a WLAN-controlled socket. To do this, the device must remain switched on. The dehumidifier then continues to operate in the same mode and with the same fan speed that was set during previous operation (automatic restart-function).

## If you do not use the device for an extended period of time

1. Disconnect the device from the mains by pulling the mains plug and bundle the mains cable properly to avoid damage.
2. Empty the water tank and dry it with a soft cloth. Replace the tank in the dehumidifier.
3. Clean the prefilter and, if necessary, remove the dirty air filter fleece.
4. Store the unit upright in a well-ventilated place (standing - never lying) and avoid direct sunlight.

## **Cleaning the dehumidifier**

Turn off the power and unplug the unit before start cleaning or other routine maintenance.

### **Cleaning the housing**

Only wipe the dehumidifier with a dry and soft cloth. To remove heavy dirt, clean the unit with a damp cloth. However, never use a damp cloth to clean the controls (touchscreen).

To avoid deformation or cracking of the housing, do not use liquid cleaners such as petrol (not even in diluted form). Dry cleaning wipes can also change the colour or surface of the device.

### **Cleaning the water tank**

Remove the water tank from the appliance for cleaning, empty the container and wash the inside of the tank with clean water. Please note that the tank may be scratched and damaged when cleaned with a bottle brush or similar objects.

Never remove the float lever from the tank. Wipe off the water on the outside of the tank with a cloth and put the tank back into the appliance according to the instructions.

### **Cleaning the prefilter -> recommendation: every 2 weeks**

The dehumidification efficiency of the dehumidifier is reduced when the filter is clogged. Remove the rear cover from the unit and remove the filter holder with the prefilter. Then carefully remove the plastic prefilter from the side tabs of the filter holder. To remove dust from the filter, use a vacuum cleaner or gently clean out the filter.

If the prefilter is very dirty, wash it with water. You can also use a neutral detergent. Finally, rinse the prefilter thoroughly with clear water and allow to dry.

### **Change of additional air filter fleece -> recommendation: every 6 months**

If you use an additional air filter fleece, it must also be replaced regularly. The service life of the air filter fleece depends on the degree of air pollution and the operating hours of the dehumidifier. However, we recommend a regular replacement after 6 months at the latest, as bacteria and germs can accumulate in the filter in connection with moisture. Remove the air filter fleece if you do not use the dehumidifier for a longer period of time and insert a new air filter fleece only before the next use.

## Technical data

Model	alfda® AEF2000
Recommended room size	20–30 m <sup>2</sup>
Dehumidification performance	20 Liter / Day 30°C / 80 %)
Water tank capacity	5,5 Liter
Power supply	220-240 V ~ (50 Hz)
Power consumption	420 W
Net-weight	14,5 kg
dimensions	Height 550 mm, length 340 mm, width 210 mm
suitable room temperature	5–32°C
Refrigerant/ Filling quantity	R290 / 60 g

Specifications are subject to change without notice for the purpose of improvement.

## Problem solving

If you have any problems, please check the following points before contacting our customer service:

Problem	Points to check	Problem solving measure
No function	Is the power cable connected?	Connect the connecting cable to the mains supply.
	Is the water tank inserted correctly?	Insert the water tank correctly according to the instructions.
	Is the water tank full?	Entleeren Sie den Wassertank.
Dehumidification performance is too low	Is the filter dirty?	Clean the filter according to the instructions.
	Is the AIR-CLEAN operating mode running?	Switch operating mode to dehumidification.



Loud operating noise during operation	Is the device installed correctly and according to the instructions?	Only use the device on a flat and stable surface.
---------------------------------------	--	---

Problem	Points to check	Problem solving measure
Operation stops during the dehumidification	Is the water tank full?  Is the room temperature higher than the normal operating temperature ?	Empty the water tank.  Dehumidification continues automatically as soon as the normal operating temperature is reached.
Wet laundry does not dry	Is the laundry in the air stream of the dehumidifier?  Is the room temperature possibly too low?	Place the appliance so that the laundry is exposed to the air stream.  Laundry is difficult to dry if the room temperature is too low. If necessary, increase the room temperature.

**Your dehumidifier has no technical defect in the following situations:**

Situation	Cause
Operation stops occasionally	The device defrosts.
Dehumidification performance is low	The dehumidification performance is low if the room temperature is too low. The dehumidification performance is also reduced if the relative room humidity is 60% or less in automatic mode.
Humidity in the room is still very high	The room may be too big. The room's doors or windows are open or are frequently opened and closed.
Odour formation during operation	Odours can escape from walls, furniture and other objects during the dehumidification process.
Dehumidifier makes noises	The circulation of the refrigerant can cause noises in the dehumidifier - especially at the start of operation - until the pressure conditions in the refrigeration circuit are balanced.
Der Summer (Signalton) ertönt	The buzzer (signal tone) sounds.



## Warranty terms

Our products are subject to strict quality control. If the dehumidifier you have purchased still does not function properly, we regret this and ask you to contact our authorised customer service.

The warranty period is 2 years from the date of purchase. The guarantee applies to the country to which the dehumidifier was delivered by the specialist dealer. During the warranty period, we will repair or replace equipment that is defective due to defects in materials or workmanship, at our option. Replaced equipment or parts of equipment become our property. The warranty services do not extend the warranty period for replaced parts, nor do they initiate a new warranty.

Warranty claims must be asserted immediately after becoming aware of the defect within the warranty period.

### **The following steps are necessary to assert the guarantee:**

Please contact customer service by e-mail ([verkauf@alfda.de](mailto:verkauf@alfda.de)) and describe the problem.

Please include your name and invoice number on the proof of purchase.

If a return is agreed, return the unit securely packaged at your expense to Customer Service.

Enclose a copy of the proof of purchase on which you note the defect. If the defect is within the scope of our warranty, you will receive a repaired or new device back postage paid.

### **Warranty claims are excluded for damages caused by:**

- abuse or improper treatment
- External influences (moisture, grease, heat, overvoltage, dust, etc.)
- Failure to observe the safety precautions applicable to the device.
- Non-observance of the operating instructions
- Use of force (e.g. impact, shock, fall)
- Interventions not performed from the service address authorized by us
- arbitrary attempts at repair
- Returned in packaging that is not safe for transport.

Furthermore, filter inserts and batteries are not covered by any warranty as they are consumables.

Defects or damage to the device that are not (or no longer) covered by the warranty will be repaired against reimbursement of costs if necessary. For an individual offer, please contact our customer service. In this case the shipping costs are at your expense.

## Notes on disposal

### Old electrical appliances should not be disposed of with household waste!

In accordance with Directive 2002/96/EC and national laws, electrical and electronic equipment must be disposed of separately from general household waste by the authorities designated for this purpose. This can be done by returning it to a retailer when purchasing a similar device or by returning it to an authorised collection point for the reprocessing of waste electrical and electronic equipment (e.g. collection points in municipalities where electrical waste can be disposed of free of charge by end consumers). As your equipment contains valuable raw materials, it may also be sold to scrap metal dealers. It is forbidden to dispose of the device with household waste or in the wild, as harmful substances can get into the groundwater. Please dispose of batteries from the remote control separately as described below:

### Notes on battery disposal

In connection with the sale of batteries or the delivery of devices containing batteries, we are obliged to inform you of the following:

You are legally obliged to return used batteries as an end user. You can return old batteries which we carry or have carried as new batteries in our range free of charge to our dispatch warehouse (Wörth 19, 94034 Passau).

The symbols shown on the batteries have the following meaning:

The symbol of the crossed-out dustbin means that the battery must not be disposed of with household waste.

Pb = Battery contains more than 0.004% lead by mass.

Cd = battery contains more than 0,002 % cadmium by mass

Hg = Battery contains more than 0.0005 mass percent mercury.

Please follow the instructions above.



#### address:

alfda Artikel für Allergiker Handels GmbH  
Wörth 19  
94034 Passau  
Germany

#### contact:

phone: +49 (0) 851 – 85 16 38 -88  
fax: +49 (0) 851 – 85 16 38 -30  
e-mail: [verkauf@alfda.de](mailto:verkauf@alfda.de)