



USER MANUAL

Air purifier ALR160

!!! PLEASE NOTE !!!

Before using first remove the foil packing form the filters inside.



Thank you for purchasing this product. The air purifier is fitted with high efficiency filters, equipped with energy-efficient and cutting-edge technology.

To get familiarized with your new product, please read the manual carefully before first use and retain this booklet for future reference.

Some housing parts are provided with protective foils to prevent scratching. Please do not remove these protective foils unless you are sure that you will keep the air purifier.

Service-address

alfda Artikel für Allergiker Handels-GmbH
Wörth 19
DE-94034 Passau
Tel.: +49 (0) 851 - 85 16 38 - 88
Fax: +49 (0) 851 - 85 16 38 - 30
eMail: verkauf@alfda.de
Internet: www.alfda.de
WEEE-Reg.-Nr.: DE 87819261

!Please note on initial operation due to cold temperatures!

Place the air purifier in a heated room for 2-3 hours before turning on the device for the first time. This will allow the engine oil to adjust itself to room temperature, so that noises will be avoided.

Table of contents

Serviceaddress.....	Page 1	7. Operation.....	Page 5
1. Short notes for use.....	Page 2	8. Filter installation.....	Page 6
2. Safety instructions.....	Page 2	9. Maintenance.....	Page 6
3. Technical specifications.....	Page 2	10. Filter replacement.....	Page 6
4. Filter structure.....	Page 3	11. Failure and Solutions.....	Page 7
5. Placement.....	Page 3	12. Warranty conditions.....	Page 7-8
6. Components.....	Page 4	13. Information of proper disposal.....	Page 8

1. Short notes for the use

The air purifier alfa ALR160 is easy to use. In addition to the built-in timer function, it can be controlled with an external conventional time switch, to turn it on or off.

For effective air cleaning, we recommend to proceed as follows:

- Ventilate extensively 2 - 3 times daily, and then turn on the air cleaner.
- In order to achieve an optimal air cleaning, the air cleaner should be operated as long as necessary to achieve twice the purification of the room air volume.

Examples for running times:

Room size	minimum running time	fan speed
~10 m ² / 25 m ³	~ 45 Min.	1 (low)
~10 m ² / 25 m ³	~ 20 Min.	3 (high)
~20 m ² / 50 m ³	~ 50 Min.	2 (medium)
~20 m ² / 50 m ³	~ 40 Min.	3 (high)
~30 m ² / 75 m ³	~ 80 Min.	2 (medium)
~30 m ² / 75 m ³	~ 60 Min.	3 (high)



Using in a sleeping room: We recommend limited running time at high fan speed after airing of the room and before going to bed. If necessary, you can use the sleep mode the entire night. The window can remain open. In the case of pollen, place the air cleaner between the open window and the bed area.

We recommend using the ionization only for a short time in the sleeping area, as this can cause poor sleep for sensitive people.

2. Safety instructions

- Please unpack the filter before use, otherwise there will be no filter effect and the air purifier can also be damaged!
- Never block the air intake and the air outlet of the unit.
- Do not place the air purifier nearby heaters, stoves, etc. and avoid grease aerosols, heat and water splashes in and near the unit.
- Please unplug the power cord when the unit is not used for a long time.
- To clean the housing do not use water or detergent to avoid damage.

3. Technical Data *)

Model	ALR160
Voltage	220-240V 50 Hz
Power min. / max. ca.	26 / 40 Watt
Power Standby	1,07 Watt
Air volume Sleep min. / medium / max. ca.	69 / 120 / 163 m ³ /h
Noise level Sleep min. / max. ca.	23,3 / 39,3 dB(A)
Net weight / Gross weight ca.	4,8 / 5,8 kg
Dimensions (L x B x H)	329 x 174 x 509 mm
Cabel length ca.	1,4 m
Insulation	Protection class II
Applicable area optimal / maximal	Up to 15 m ² (37,5 m ³) / up to 30 m ² (75 m ³)

*) based on unused alfaCleanAIR-Filter.

4. Filter structure



Filter element alfdaCleanAIR (Standard-version).....Part.-No.:157596

Consisting of **blue textil pre-filter** (cotton) to filter coarse dust, **HIMOP-filter** (High Efficiency Multi oxidation pottery and Porcelain Granule Efficiency Particulate Airfilter): with high filter-performance. • **HEPA filter** (High Efficiency Particulate Airfilter): of high efficiency. Removes smoke and dust of 0,3 µm. The filtrating rate is as high as 99%.



Filter element alfdaAntiSMOKE (alternative 1).....Part.-No.:157597

Consisting of black **textil pre-filter** (cotton) to filter coarse dust, **HEPA-Active-Carbon-Special-filter** with high storage capacity for harmful gas, smoke and odors. Filtration rate: > 99,5% for charges up to 0,1 µm according to EN 1822-1:2009



Filter element alfdaTrueHEPA (alternative 2)

Consisting of 2 filter-sets

FILTER ELEMENT 1.....Part.-No.:157598

The green textil pre-filter (cotton) to filter coarse dust and with additional antibacterial effect, the fine dust filter for filtering dust and allergen load.

Filtration rate: 90-95% with up to 0,4 µm particle size.

FILTER ELEMENT 2.....Part.-No.:157599

The HEPA-Filter (High Efficiency Particulate Airfilter): with high filter-performance of suspended matter and finest particles/allergens. Filtration rate: > 99,95 % for charges up to 0,1 µm according to EN 1822-1:2009

- **Ionizer (can be switched ON / OFF):** To generate negative charged ions (capacity: 10.000.000 / cm³) and to refresh indoor air.
- **Dunen-filter** – Additional-filter (optional).....Part.-No.:157744
Consisting of a washable special-filter-fleece which filtrates bird-feather-dust and protects the main filter element.

5. Placement

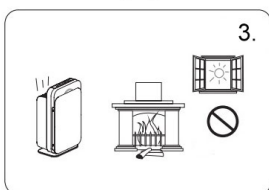
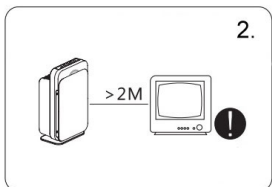
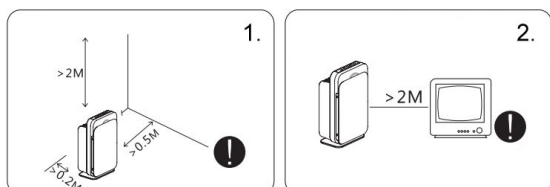

1. Keep at least 20 cm distance to the wall, 50 cm distance to the air inlets and 2 m distance to the ceiling.
2. Keep 2 m distance to any Multi-Media-Products.
3. Do not place the air purifier directly into the sun. The air purifier does not replace the necessary ventilation (oxygenation) especially in rooms with fireplaces.
4. **Important: The air purifier is not suitable to filter greasy air! It is not suitable to be placed in production areas!**
5. To ensure the best possible air cleaning, the room layout has to be taken into consideration when placing the air purifier.

Following some samples for placing the air purifier:

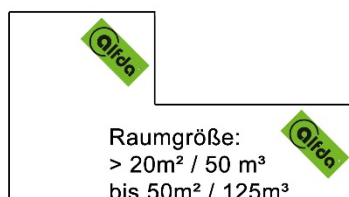
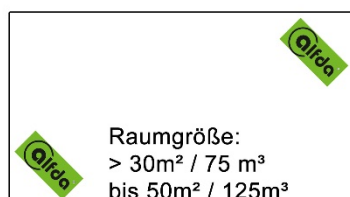
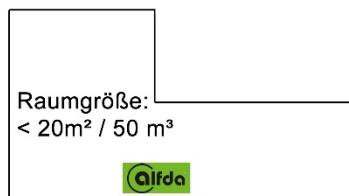
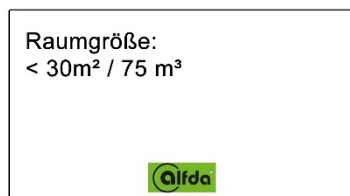

If the room size is larger than 30 m² / 75 m³ or the room is very winding, you may need to place 2 air cleaners.

To get the best result of air cleaning, place the unit where air circulation is good and place the unit near the source of polluted air.

6. Components



- (1) Operation panel
- (2) Display
- (3) Front panel
- (4) Air inlet



- (1) Carrying handle
- (2) Air outlet
- (3) Ionizer
- (4) Label
- (5) Power cord

Operation panel and display of the air purifier:

Operation panel



- (1) Logo - No function
- (2) Ionizer On / Off
- (3) Fan speed
- (4) On / Off (Power-toggle)
- (5) Timer function
- (6) Sleep-Mode

Display



- (1) Fan speed & sleep-mode in dimmed light
- (2) Ionizer On / Off
- (3) Fan speed
- (4) Receiver remote control
- (5) Timer

7. Operation

Method of Operation

Connect the power cord: By pressing the power button, the air cleaner starts to operate at the preset fan speed, the ionizer is switched off and the display shows the set operating mode.



On / Off-button: Pressing the power button, the unit will be switched off/on.
If the unit is switched on again, the last selected mode will be activated and can be changed then.



Fan Speed-button: Press the button for selection of the fan speed (Min-Med-High). The display shows the current speed.



By using the timer function, the running time of the fan can be set from 1 to 12 hours. The device switches off automatically after the set running time has elapsed. The timer function can be combined with all other settings. *)



If the **Sleep-Mode** is selected, the air purifier works very silently with reduced air quantity. The display will be dimmed so that the lights do not interfere in a dark room. The sleep-Mode can be combined with timer-function and / or ionizer. By pressing any button, the sleep-mode will be switched off.



Press the button for Ionizer. The operation will be shown on the display.

*) Setting options of the timer function: 30 minutes interval-setting for 1-10 hours and 1 hour interval-setting for 10-12 hours

External timer: The air purifier can be connected with an external timer to set the working time. When the unit is switched on, the initial mode will be set to the last used fan-speed. This also applies for the ionizer. The external timer is not included in the scope of delivery.

Remote control

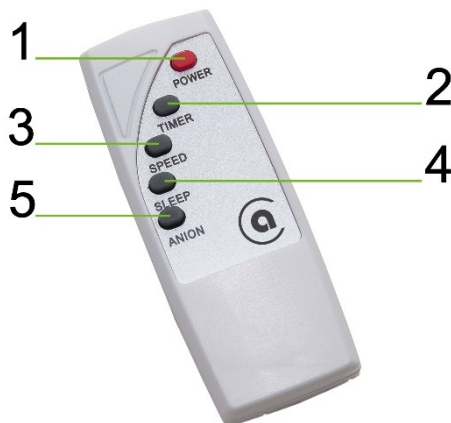

- (1) On / Off Button (Power toggle)
- (2) Timer-function
- (3) Fan speed
- (4) Sleep-Mode
- (5) Ionizer On / Off

Using the remote control

The functions are identical to the operating modes to be set via the function buttons on the device.
Point the remote control at the front of the air purifier and select the desired setting.

8. Filter installation



1. Remove the front panel as shown. First undo the magnet holder at the bottom and lift upwards.



2. Rotate the four fasteners of the main filter element 90 degrees, so that the filter element can be removed.



3. Remove the filter-set as shown and remove the foil packing.

· purifier the first time, remov

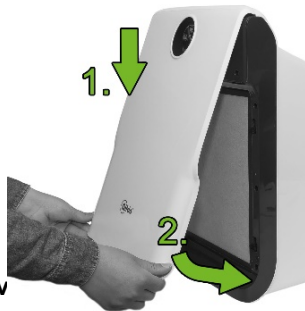

4. Replace the filter element with the cotton-filter (blue, black or green) facing toward you. Lock the mounting brackets to secure the filter element and replace and mount the front panel.

ilters inside.

Before using the air purifier the first time, remove the foil packing from the filters inside.

Note on filter insert alfaTrueHEPA

The filter insert alfaTrueHEPA consists of 2 HEPA filters. First, insert the white HEPA filter (filter element 2) into the device with the grip tabs facing forward. Then insert the HEPA filter (filter element 1) with the green cotton filter facing towards you.

9. Maintenance

For maintenance please disconnect the unit from power to avoid an electric shock. Never clean the filters with water to avoid changes to the shape of the filters. The pre-filter and the blue cotton filter should be cleaned carefully with a vacuum cleaner every 4-6 months.

10. Filter replacement

The average durability of the multi-filter is up to 1.5 years with a daily 4-hour operation. The extent of use and the amount of air pollution and/or strong tobacco smoke for example will shorten the usage time of the filter.

If the unit is not used for a long time, we recommend removing the filter from the unit and placing it inside an airtight foil.

Please note that the alfaAntiSMOKE-Filter element loses its effect in case of non-use. Therefore it should be used latest after 2 month of purchase.

The maximum odor and pollutant-filtering effect of the alfaAntiSMOKE-Filter element is 1 year after unpacking the filter.

Replacement filters are available on: www.allergiker-shop-alfda.de

The corresponding part numbers you can find on page 3 / point 4 (Filter Construction)

11. Failure and Solutions

Please refer to the following before contacting Customer Service Centre for service / repair:

Unit does not work: Check if the power cord is plugged in correctly, power is available and the front panel is installed correctly.

The Remote Control does not work: Please check whether the battery is placed correctly and has enough capacity. First try changing the battery. The remote control must be directed at the unit's front side with the IR-Receiver.

The unit is noisy: Check if the foil on the filter is still inside and remove it. Also check the pollution level of the filter-element. A polluted filter can also be the reason for more loudness.

Reduced air flow at the air outlet: Please make sure that the air outlet is not blocked. If the filter element is increasingly saturated by particles, dust and allergens, it should then be replaced with a new filter.

Odors or dirt in the air are not being filtered. Loud operation noise level:

Please make sure, that air inlet and air outlet are not blocked and clean them carefully with a vacuum cleaner. Take the filter unit out of the air purifier and clean the filter-set carefully with a vacuum cleaner or replace the filter-set with a new one.

Using the alfaCleanAIR-Filter element: There is the possibility to reactivate the HIMOP filter (odor filter) - Please remove the textile pre-filter and place the filter element in the sunlight for several hours. **NOTE:** The dark side has to be upwards. Hereby the function of the HEPA-Filter is not affected, also the durability is not extended.

Using the alfaTrueHEPA-Filter element: Only particle-borne odors can be filtered, gaseous odors remain unfiltered. If necessary please use the alfaCleanAIR-Filter element or the alfaAntiSMOKE-Filter element.

In case of no improvement, the filter element has to be replaced

12. Warranty conditions

Our products are subject to strict quality control. If your air purifier should still not be functioning properly, we regret this and ask you to contact the authorized customer service.

The warranty period is 2 years from date of purchase. The guarantee is for the country to which the air purifier was delivered from the dealer. Devices, that have material and workmanship defects are repaired or replaced at our discretion during the warranty period. Exchanged devices or parts of devices become our property. It does not extend the warranty period nor does it initiate a new warranty in transition.

Warranty claims must be submitted immediately after becoming aware of the defect within the warranty period.

In order to claim the warranty service involves the following steps:

Please contact the customer service by e-mail (verkauf@alfda.de) and describe the problem. Please note the invoice number and your name in this e-mail.

If a return is agreed upon, send the unit securely packaged at your expense to our service. Include a copy of the invoice on which you note the defect. If the defect is under our warranty, you will get a repaired or new device sent on our costs.

Warranty claims are excluded for damage caused by:

- Misusage or improper treatment
- Unusable conditions (moisture, fat, heat, over voltage, dust, etc.)
- Failure to follow the safety precautions applicable to the device
- Not following the instructions
- The use of force (eg. drop, shock, impact, dump down, etc.)
- Procedures that were not performed by the address of our authorized service
- Unauthorized attempts to repair
- Unsecure and non-transportable packaging.

Furthermore, consumable parts such as batteries and filter cartridges are not subject to any warranty !!

Defects or damage to the device not covered (or no longer) by the warranty will be corrected if necessary, against costs. For an individual quotation, please contact our customer service.

In this case the shipping costs are at your expense.

© Händlerbund e.V. (erstellt von Rechtsanwalt Andreas Arit, Stand: 12.12.2011)

13. Information of proper disposal

Old electronic equipment is no household waste!

In accordance with Directive 2002/96/EG and national laws, electrical and electronic equipment must be separated from general household waste using the sites designated by local authorities. This can be done by returning the product when purchasing a similar device or by sending it to an authorized collection point for the reprocessing of WEEE. Please discard batteries from the remote control as follows:

Notes on Battery Disposal

In connection with the sale of batteries or with the delivery of equipment containing rechargeable batteries, we are obliged to draw your attention to the following:

As an end-user, you are legally obliged to return used batteries. You can return waste batteries that we carry in stock or have had in the past, free of charge to our warehouse (Wörth 19, 94034 Passau).

The symbols shown on the batteries have the following meaning:

The symbol of the crossed out wheeled bin indicates that the battery should not be treated as household waste.

Pb = battery contains more than 0.004 percent lead

Cd = battery contains more than 0.002 percent cadmium

Hg = battery contains more than 0.0005 per cent of mercury.

Please note the above instructions.

**Address:**

alfda Artikel für Allergiker Handels-GmbH
Wörth 19
DE-94034 Passau

Contact:

Telefon: +49 (0) 851 - 85 16 38 - 88
Telefax: +49 (0) 851 - 85 16 38 - 30
E-Mail: verkauf@alfda.de



